

Rules and Regulations

Bavarian Curling

Organizer: MAKKABI Deutschland e.V.
in Cooperation with the German Ice Stock Association and Special Olympics Bavaria

Competition Management: Christian Rimsl (German Ice stock Association);
Contact wintergames@makkabi.de

Remark: In all competitions, players of all ages compete in mixed groups.

Disciplines: Single, Team, Number Shooting

Equipment: The ice sticks are provided by the organizer. The participants themselves are responsible for suitable clothing and safe footwear (non-slip soles).

Venue: The competitions will be held in the ice rink Ruhpolding. Concrete competition times will be announced by the Organizing Committee in due time.

The judging panel takes the rules of the Special Olympics Germany (SOD Rules) as a basis for the execution and for its decisions.

These rules are subject to change and will always be communicated in time.

Irregular Conduct

- ✳ The player on the play-off spot must not be disturbed (interference from a distance) or obstructed (physical contact by opposing players) during his attempt. In case of clear interference or obstruction, attempts may be repeated.
- ✳ Players and coaches are not allowed to interfere with a stick or stave ("Daube") in play.
- ✳ No one is allowed to be in or in front of the target field during the execution a trial. The target field may only be entered to measure, to insert the stave or to adjust sticks or the stave.
- ✳ The players and coaches should stay behind the playing field. In case of lack of space behind the playing field, they are allowed to stay between the fields, but not more than up to the front boundary line of the playing field, and go to the target field only after the completion of the turn (after the result has been determined). Substitutes are not allowed to enter the playing field.

Competition guide

Single - target competition

The playing field consists of the target field, the play-off field and the lane in between. Players and coaches stay exclusively in the area of the play-off field.

The target field consists of 5 rings in the middle of which a stave is placed. The rings count from outside to inside 2, 4, 6, 8 and 10 points.

- ✳ Before the start of the competition, all participants are allowed a maximum of 5 trial attempts
 - If you do not want to use a trial, this must be clearly signaled to the refereeing panel
- ✳ The objective is to place his ice stick as close as possible to the stave

Preliminaries

- ✳ Each player has 7 attempts, the best 6 are counted
- ✳ Ranking and pairings for final

Finals

- ✳ Depending on the number of registered starters, a corresponding tournament tree will be created for the final pairings and the ranking duels will be played out
 - As in the preliminary round 7 attempts, the best 6 are counted

Team - target competition

The playing field consists of the target field, the play-off field and the lane in between. After the captain has made his attempt, he can stay near the target field to communicate instructions to his teammates.

Teams

The referee panel will announce in due time whether teams of 4 or 3 players will play.

Up to 2 substitutes are allowed. The substitution is only allowed between matches.

The results of the individual competition will be used to create the tournament tree for the teams. There will be no team preliminaries.

Gameplay

- ✳ All players on a team must score one try per turn
 - This does not include the substitutes
- ✳ There will be 4-6 turns played per match depending on registration numbers
- ✳ Teams take turns shooting the stick
 - If the stick of the starting player does not land in the target area, the others from the team play until a stick remains in the target area
- ✳ The starting team changes after each turn.
- ✳ A turn can be ended early with mutual agreement of the captains (possible reason: position change of the stave or sticks).
 - The score at that moment is valid.
- ✳ If the sticks or the stave are changed in their position by external influences (e.g. players, sticks from other lanes), they will be put back to their original position.
- ✳ It is not allowed to throw the stick with its whole circumference over the front boundary line of the play-off field.
 - This stick is considered as thrown over and must be repeated with the same stick.

Scoring

- ✳ In each turn a maximum of 4 or 3 points can be scored.
 - Each stick that is closer to the stave than the closest stick of the opponent gets one point.
 - If the distance is the same, no points are given

Number shooting (batten competition)

The playing field consists of the target field, the play-off field and the lane in between. Players and supervisors stay exclusively in the area of the play-off field.

Gameplay

- ✳ The goal is to play as centered as possible on the batten frame (Fig. 2)
- ✳ Each player has 7 attempts, the best 6 are scored
- ✳ If two batons are touched by the stick, the higher score counts
- ✳ After the preliminary rounds, the rankings are played out in the final pairings

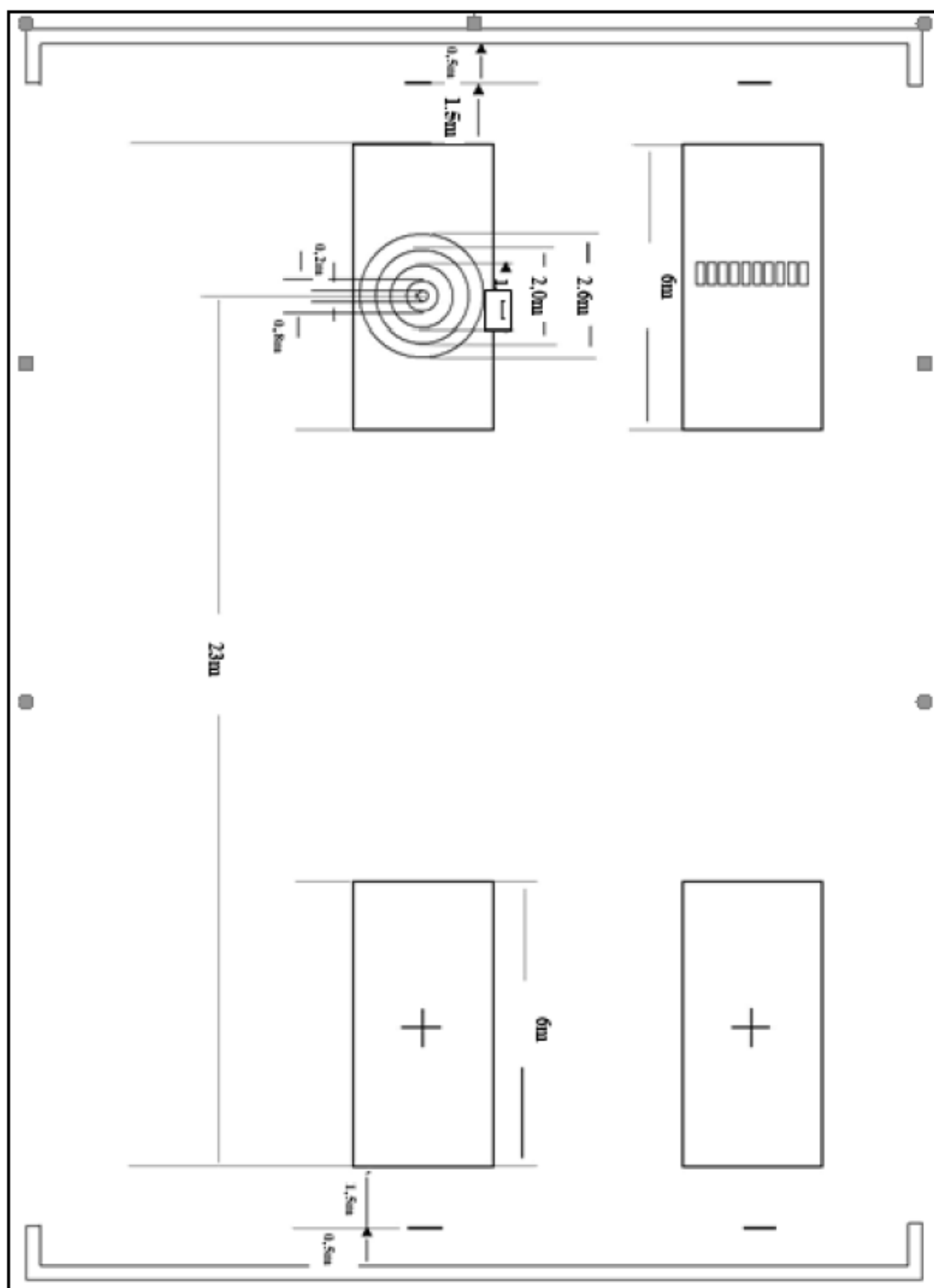

Fig.1. playing field target competition (left) and number shooting (right); SOD rules 2022



Fig.2. batten frame with scoring points); SOD rules 2022